



Community Hall

Dialogue

The need for a dialogue about a Community Hall

- A hall that served our community for nearly 90 years until it was condemned as structurally unsafe in 2017.
- We have had to rely on properties owned by others.
- What do we want to serve us and our descendants for the next 90 years?
- As part of an ongoing dialogue with Parishioners, we asked you complete three key questions related to the idea of a Community Hall.

Three Key Questions & The Approach

- What does the idea of a community hall mean to you?
- Who could benefit from a community hall?
- What sort of activities could you imagine happening in, or connected to, a community hall?
- A team of Councillors canvassed the parish: knocking on doors and putting question cards through letter boxes.
- The three questions were included in the Parish's NDP Survey, which allowed for more responses to be gathered
- Approximately 200 responses and a 37 page document.

What does the idea of a community hall mean to you?

- A place to hold community events, meetings and regular groups. To enable parishioners to meet regularly or rent out and that it is accessible
- Somewhere locals can use for local events,
- Where neighbours get together if they wish - good for people who are on their own.
- A place where you could approach community support people, such as a PCSO. An information hub where you can meet locals and offer DIY trades, etc.
- A place the community can use to improve wellbeing.

What does the idea of a community hall mean to you?

- A subsidised meeting place which is accessible to all members of the community. It should be affordable to all.
- Somewhere for community activities and a place to rent for parties/family gatherings.
- Some community spirit to link the parish is very exciting.
- A good location for a play park outside the village hall. A good community hall gives the opportunity for local groups to gather.

Who could benefit from a community hall?

- All who live in the parish. Also visitors and neighbouring parishes who may wish to join.
- Community groups and clubs. Young mothers and senior citizens.
- Across the board from young families wanting help with young children to older generations socialising.
- If used correctly, youth clubs, etc. Needs to have a policy of inter-generational open engagement in Youth Clubs, etc
- There are a lot of lonely people in the area.

Who could benefit from a community hall?

- Non parishioners would also use or contribute financing.
- People who are lonely.
- The most deprived members of the community.
- Small businesses that run, say, a gym, groups for children to older persons' lunch-social clubs.
- Locals in the parish, plus the wider community and beyond, if a new hall is used imaginatively.

What sort of activities could you imagine happening in, or connected to, a community hall?

127 different activities imagined. Of these, the most popular were:

1. Arts & Crafts fairs & groups - 30
2. Parent/Mothers & Toddlers & Nursery - 28
3. Parties & Private functions - 27
4. Meetings - 20
5. Keep Fit - 19
6. Sports Club / Parish (Council) Meetings - 15
8. Fundraising / Social Gatherings - 14
10. Coffee mornings / Playgroups / Yoga / Wedding Receptions - 13.

What next?

- Everything everywhere at once.
- Location(s)?
- Old Parish Hall?
- Funding?
- Creating, establishing and sustaining?

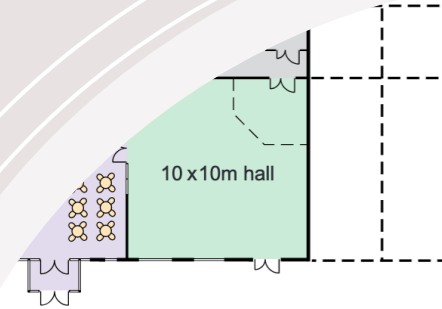

Smallest hall with the minimum support accommodation shown with potential extensions.

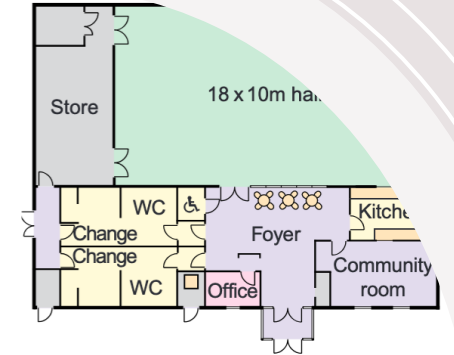

One-court badminton size hall with compact ancillaries including combined WCs and cha

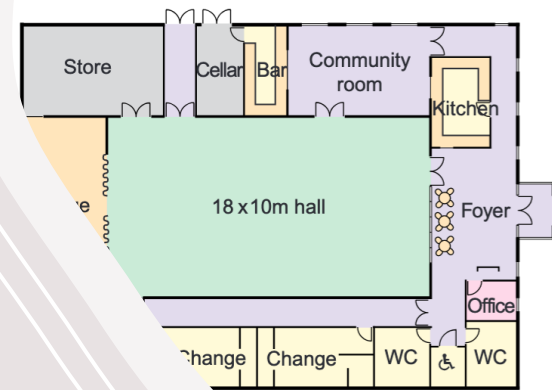

Accommodation around



Centre with a room service